

FOUL POLE

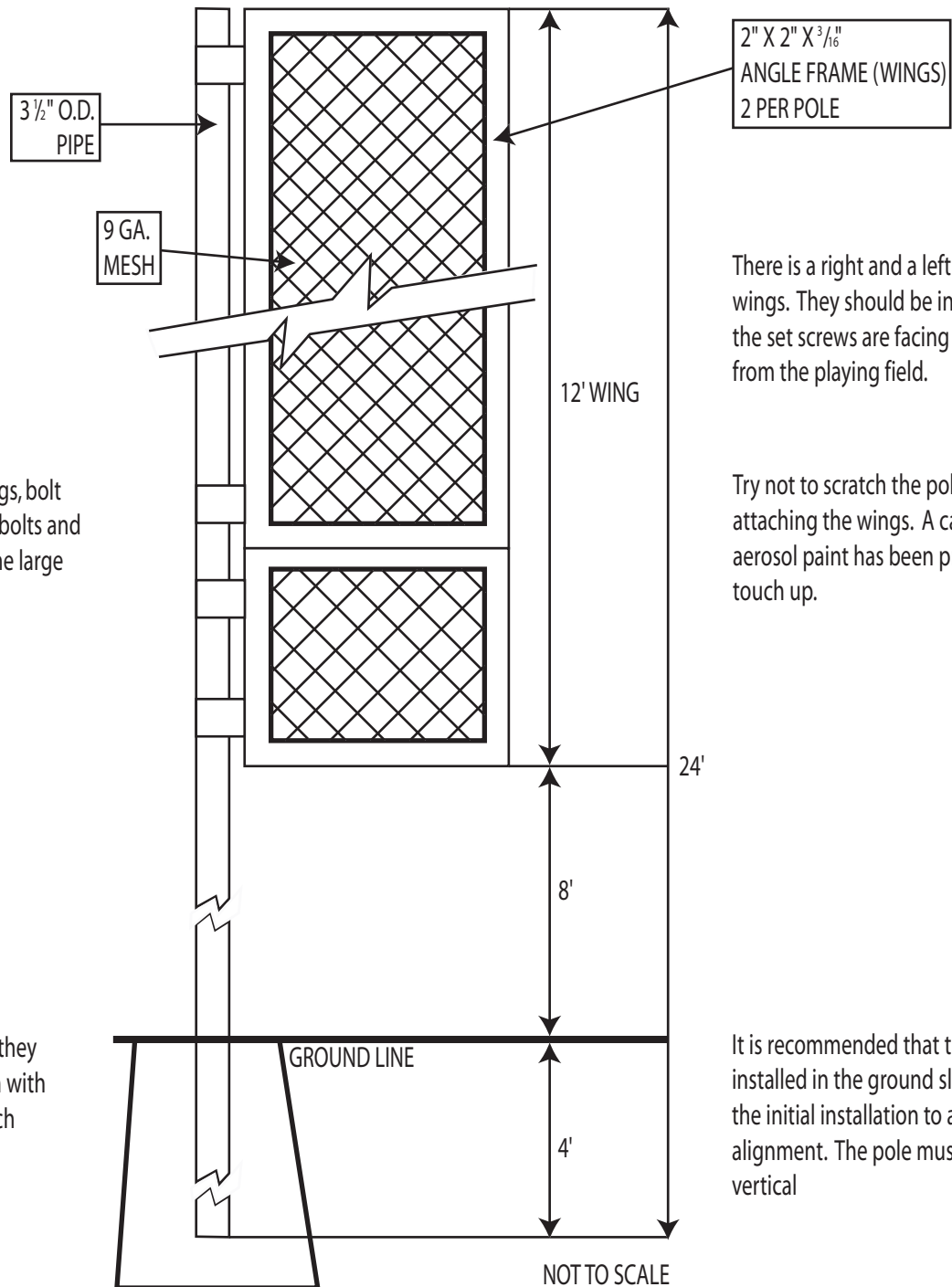

After positioning the wings, bolt them together using the bolts and nuts provided. Tighten the large set screws.

There is a right and a left to the wings. They should be installed so the set screws are facing away from the playing field.

Try not to scratch the poles when attaching the wings. A can of aerosol paint has been provided for touch up.

If using ground sleeves, they should be installed flush with the ground and the notch at the top.

It is recommended that the pole is installed in the ground sleeve during the initial installation to aid in the alignment. The pole must be perfectly vertical